

Martin Fiss

Evan Owen

Page - 110

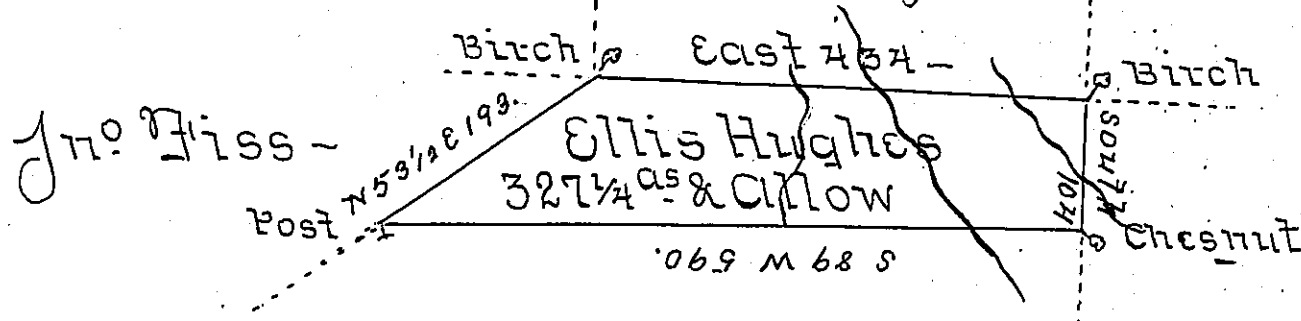

Vacant -

A Draught of a Tract of Land Situate on a Branch of Loyalsock Creek Adjoining Land of Evan Owen & others in Loyalsock Township in the County of Northumberland Surveyed on the Second day of November 1788, for Ellis Hughes in Pursuance of his Warrant, bearing date the first day of July 1784. Containing Three Hundred & Twenty Seven Acres & one Quarter with the Allowance of six Per Cent for Roads &c ~

This Warrant was Remov'd from the Waters of Catawassa Creek, the Land being Appropriated, as appears by a Certificate, under the Hand of the Deputy Surveyor of that District &c ~

No. John Lukens Esq. }
Surveyor Genl. }

Jo. J. Wallis DS

IN TESTIMONY that the above is a copy of the original remaining on file in the Department of Internal Affairs of Pennsylvania, made conformably to an Act of Assembly approved the 16th day of February, 1833, I have hereunto set my Hand and caused the Seal of said Department, to be affixed at Harrisburg, this seventh day of December 1904.

James P. [Signature]
Secretary of Internal Affairs.